

Product Data Sheet

F-Series Linear Actuator

SHIFT AUTOMATION

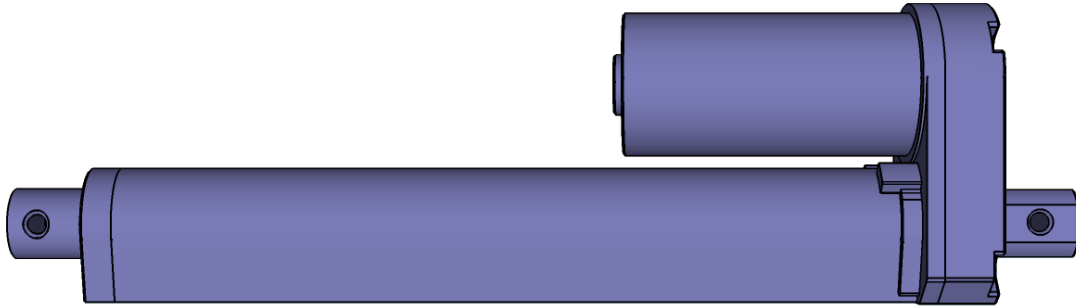

Key Features

- High strength brass drive nut
- Compact and powerful
- Metal gears
- Engineered for smooth, stable movement through the entire stroke length
- Multiple support structures to provide robust performance
- IP54, dust and weather resistant

Technical Data

	SA-200-F	SA-650-F
Voltage	12VDC Standard (24VDC optional)	
Current Draw	At 12VDC, 1.75A at no load, 8A at full load	
Speed at no load	0.8"/s (20mm/s)	0.35"/s (9mm/s)
Dynamic Force	200lb (90kg)	650lb (295kg)
Holding Force	250lb (113kg)	700lb (317kg)
Duty Cycle	20% (2 min ON, 8 min OFF)	
IP Rating	IP54, dust and weather resistant	
RoHS	Yes, RoHS certificate	

Product Data Sheet

F-Series Linear Actuator



Performance Characteristics

Speed vs. Load for SA-200-F

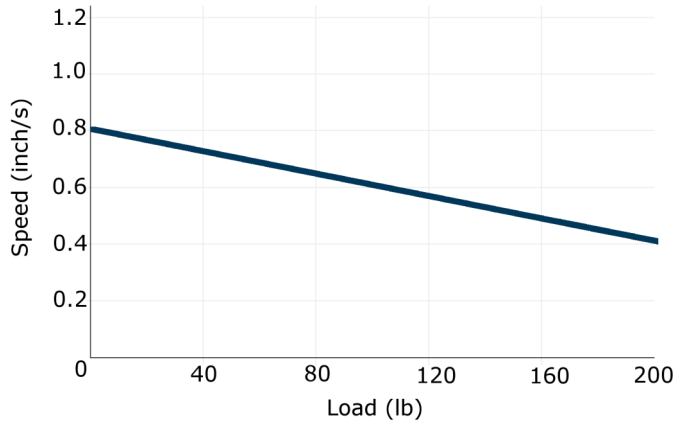

Speed vs. Load for SA-650-F

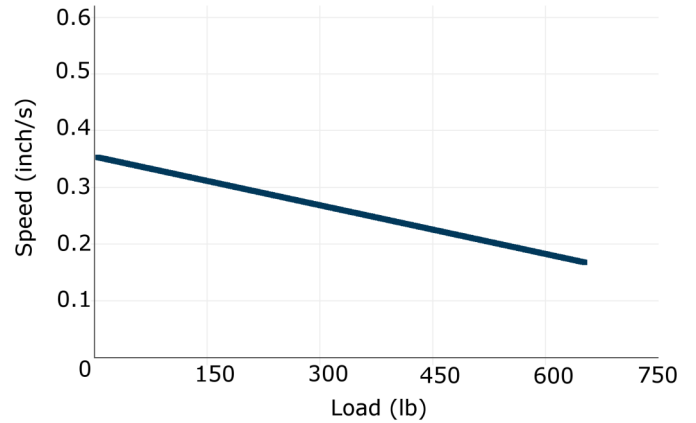

Electrical Installation

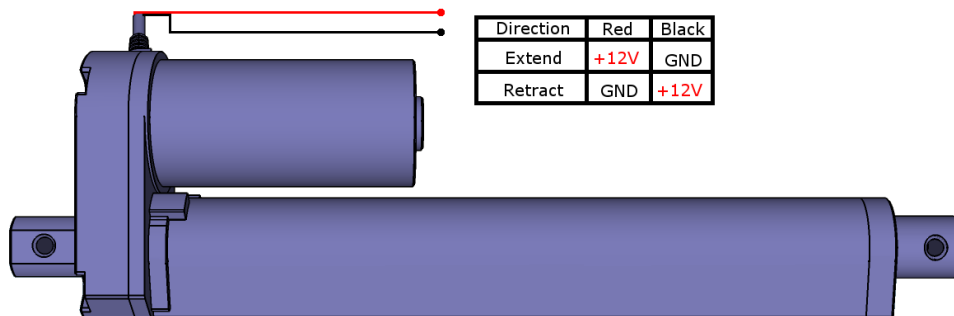

Product Data Sheet

F-Series Linear Actuator



**RoHS
Compliant**

SHIFT AUTOMATION

www.ShiftAutomation.com

Product Parameter	
Input Voltage	12VDC
Front Hole Dia.	0.32 +/- 0.01"
Rear Hole Dia.	0.32 +/- 0.01"
Power Cable	Twin Core 18AWG
Protection Grade	IP54
Limit Switches	Built-in

Hole to Hole dimensions			
Model	L	S	L+S
SA-xxx-F-12-2	6.96"	2"	8.96"
SA-xxx-F-12-4	8.96"	4"	12.96"
SA-xxx-F-12-6	10.96"	6"	16.96"
SA-xxx-F-12-9	13.96"	9"	22.96"
SA-xxx-F-12-12	16.96"	12"	28.96"
SA-xxx-F-12-18	22.96"	18"	40.96"
SA-xxx-F-12-24	28.96"	24"	52.96"

